

MARION TOWNSHIP SECTION 11 R12 TWP 8 MORGAN COUNTY, OH

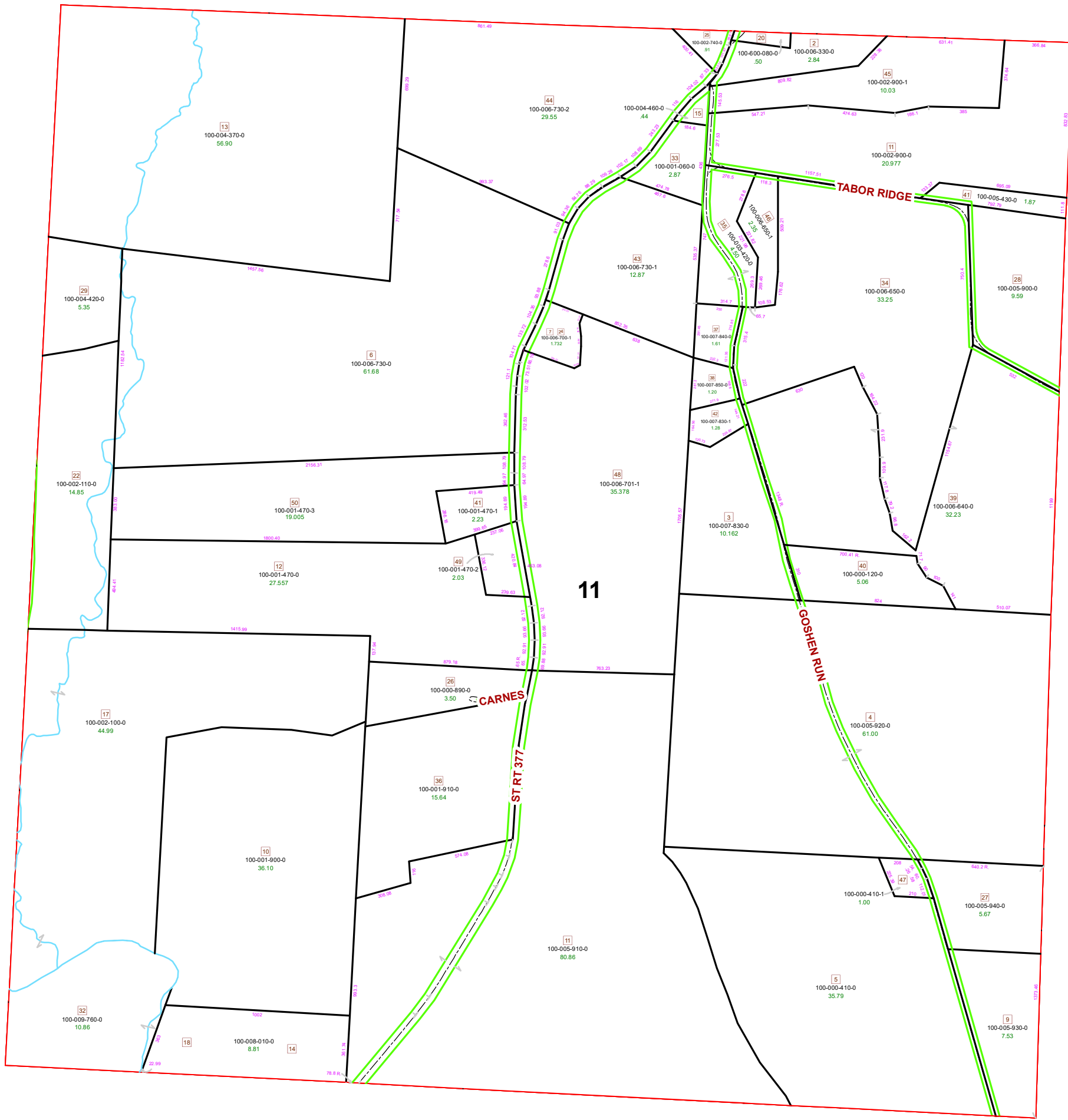

PIN	Owner	VOL	PAGE	LegalDescr	Acres
100-000-120-0	ARMSTRONG RYAN M & KELSEY A HINKLE	OR224	2928	R12 T08 S11 SD 40	5.067
100-001-470-2	BOONE JAIME	OR231	4051	R12 T08 S11 SD 49	2.035
100-006-701-1	CAIN RONALD S	OR218	655	R12 T08 S11 SD 48	35.378
100-001-060-0	COLUMBIA GAS OF OHIO INC ATTN: TAX DEPT	D.V 129	249	R00 T00 S11	2.872
100-000-410-0	CREIGHTON ANNA E	OR113	563	R12 T08 S11 SD 5	35.799
100-006-730-2	FLEMING CODY R	OR219	1696	R12 T08 S11 SD 44	29.554
100-001-900-0	FOSTER CHARLES R JR	OR186	189	R12 T08 S11 SD 10	36.1
100-001-910-0	FOSTER CHARLES R JR	OR186	189	R12 T08 S11 SD 36	15.64
100-002-100-0	FRAZIER DIXIE ANN	OR97	75	R12 T08 S11 SD 17	44.99
100-002-110-0	FRAZIER DIXIE ANN	OR97	75	R12 T08 S11 SD 22	14.85
100-008-010-0	GINGERICH LEVI	OR210	2502	R12 T08 S11 SD 14-	8.815
100-005-430-0	GRAHAM MELVIN & DELORES	OR140	513	R12 T08 S11 SD 41	1.874
100-009-760-0	JACKSON AARON & ADAM & ADESSA	OR190	236	R12 T08 S11 SD 32	10.86
100-006-700-1	LACY STEVEN L & SHEILA D	OR152	469	R12 T08 S11 SD 7 &	1.732
100-007-830-1	MARQUIS STEVEN R	OR234	1351	R12 T08 S11 SD 42	1.288
100-002-900-1	MATHENY NICHOLE S & WILLIAM BLAKE II	OR227	2815	R12 T08 S11 SD 45	10.032
100-000-890-0	MAYLE DOWDEN C & BONITA	D.V 187	795	R12 T08 S11 SD 26	3.5
100-006-650-1	MAYLE SETH & AMBER	OR220	965	R12 T08 S11 SD 46	2.35
100-002-900-0	MCCUNE ROBERT W & SALLY K	OR233	3845	R12 T08 S11 SD 1	20.977
100-000-410-1	METCALF JOHN & DOROTHY	OR154	719	R12 T08 S11 SD 47	1.001
100-006-730-1	MILLER HENRY L & POLLY D	OR218	2994	R12 T08 S11 SD 43	12.87
100-001-470-0	MILLER VERNON RAY & BETTY J MILLER ALAN E & MIRIAM	OR233	670	R12 T08 S11 SD 12	27.557
100-005-910-0	MOODY SUSAN ANN	OR175	583	R12 T08 S11 SD 11	80.86
100-005-930-0	MUETZEL ROBERT N ET 2 AL	D.V 157	763	R12 T08 S11 SD 19	7.53
100-005-940-0	MUETZEL ROBERT N ET 2 AL	D.V 157	763	R12 T08 S11 SD 27	5.67
100-005-920-0	MUETZEL ROBERT N ET 2 AL	D.V 203	21	R12 T08 S11 SD 4	61
100-005-900-0	NICESWANGER LUCAS M	OR234	2250	R12 T08 S11 SD 28	9.59
100-006-330-0	OLNEY ALLEN	D.V 188	299	R12 T08 S11 SD 2	2.84
100-006-640-0	PETERS JAY NELSON & BECKY J	OR231	150	R12 T08 S11 SD 39	32.233
100-006-650-0	PETERS JAY NELSON & BECKY J	OR231	150	R12 T08 S11 SD 34	33.25
100-001-470-1	SEIBEL NEIL R	OR212	2160	R12 T08 S11 SD 41	2.239
100-001-470-3	SEIBEL NEIL R	OR233	3461	R12 T8 S11 SD50	19.005
100-004-420-0	SHAW CHRISTOPHER A	D.V 200	24	R12 T08 S11 SD 29	5.35
100-004-370-0	SHAW CHRISTOPHER A	D.V 200	24	R12 T08 S11 SD 13	56.9
100-006-730-0	SHAW CHRISTOPHER A & GINAH L	OR160	454	R12 T08 S11 SD 6 S	61.689
100-007-830-0	STANLEY GARY CURTIS JR	OR233	1623	R12 T08 S11 SD 3	10.162
100-007-850-0	STANLEY ROLAND G & KATHLEEN	D.V 153	331	R12 T08 S11 SD 38	1.2
100-007-840-0	STANLEY ROLAND G & KATHLEEN	OR203	2804	R12 T08 S11 SD 37	1.61
100-004-460-0	TABOR RIDGE CHURCH OF CHRIST	OR212	6	R12 T08 S11 SD 15	0.441
100-003-420-0	TAYLOR RENTALS LLC	OR215	3181	R12 T08 S11 SD 35	4.507
100-600-080-0	TODDS COMMUNITY CHURCH	OR233	575	R12 T08 S11 0	0.5
100-002-740-0	ZAAAYER JAMES B	OR226	803	R12 T08 S11 SD 25	0.91

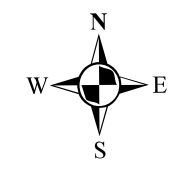

Boundaries	
----- Hidden	--- ROW
--- Hydro	--- Section
--- Roads	--- Lot
--- County	--- Township
--- Parcel	--- Parcels

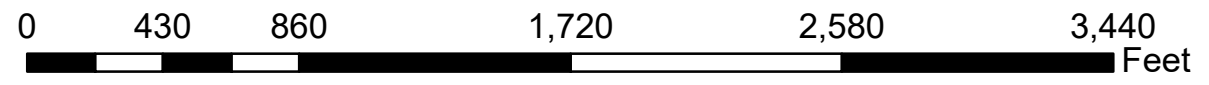

Disclaimer: The information that these maps contains is for reference purposes only. Please bring any erros to the attention of the Engineer's Office staff.
Thank you

Source: Morgan County Engineer's Office
Author: Marcia Wolfe
Date: 7/9/2020